

# INSTALATION GUIDE RADIATION SHIELD

Follow these step-by-step instructions to assemble the sensor for your measurement system.

## Main parts:

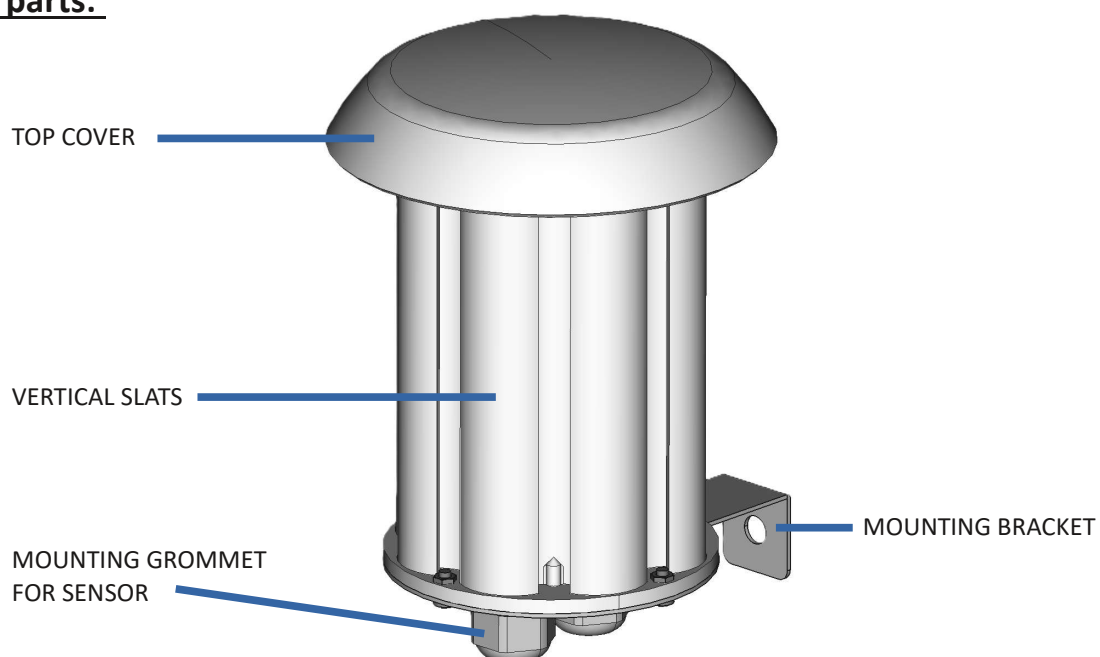

## Dimensions:

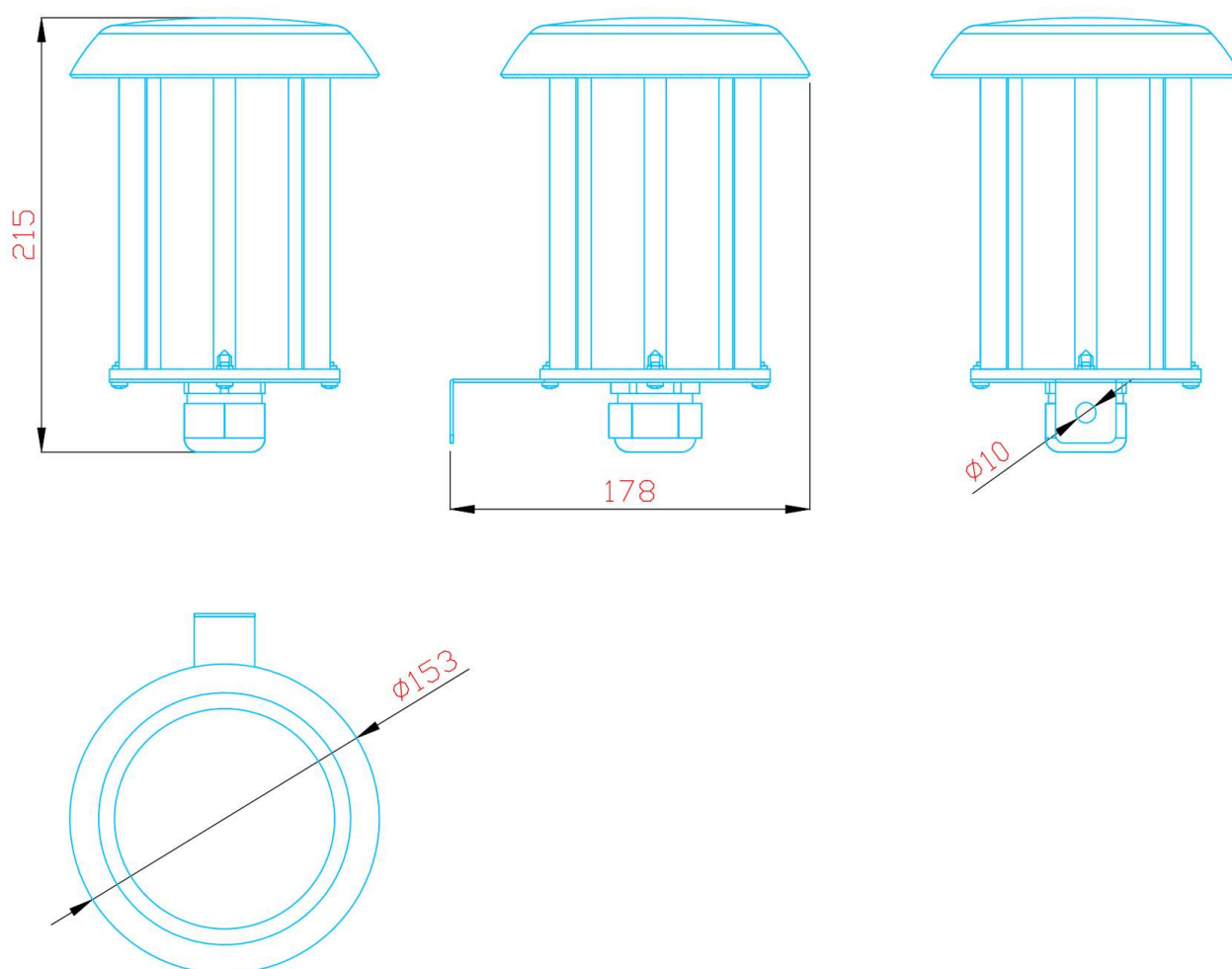

## **Installation:**

Install the *Radiation shield* at a sufficient distance from obstacles to ensure that the measurements are not affected by environmental influences.

- Mount the *Radiation shield* on a suitable stand at least 1 meter above ground level.
- Insert the sensor into the grommet so that the active part of the sensor is positioned as high as possible within the inner space, ideally in the center.
- Tighten the grommet appropriately using a spanner.
- Secure the sensor cable to the mounting pole.

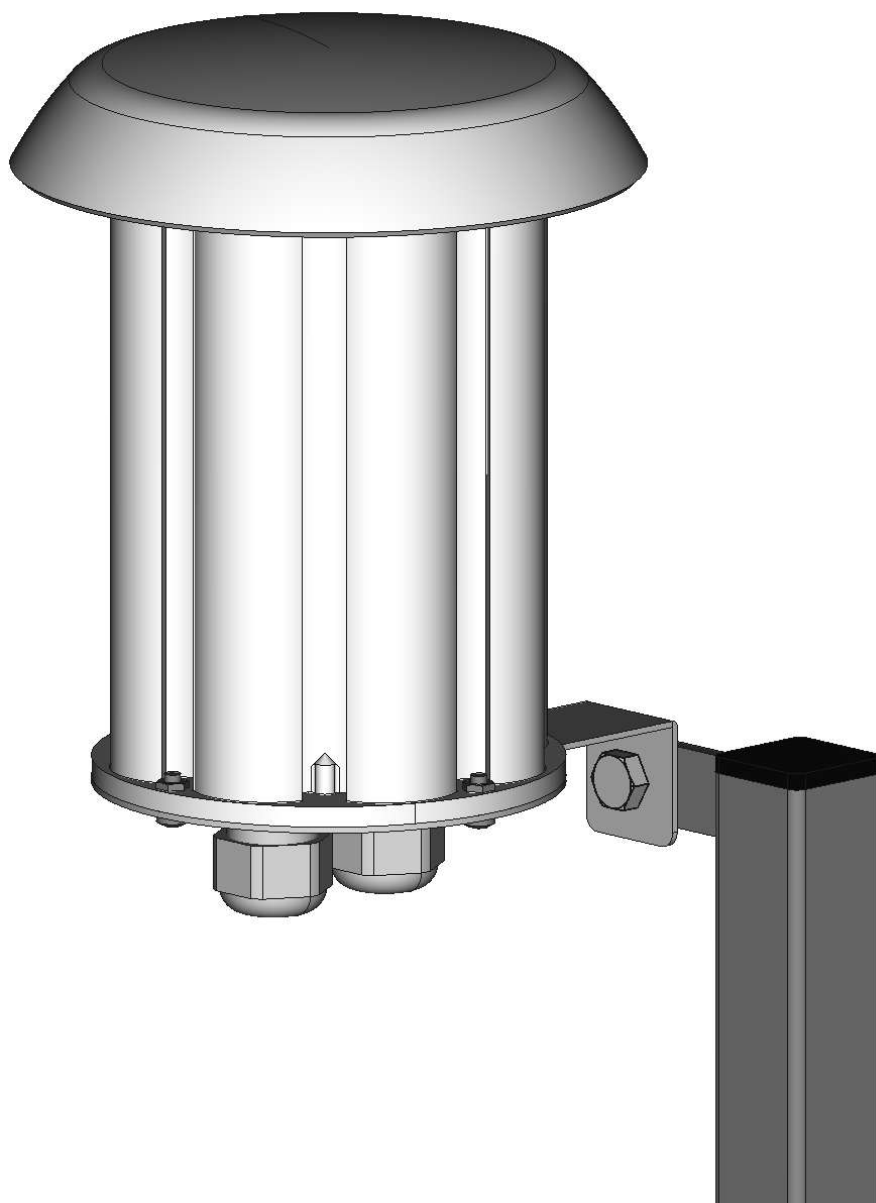

**Note: Two bracket versions are available:**

- 2x PG16 – for two sensors with a diameter of 9–15 mm
- 1x PG29 – for one sensor with a diameter of 15–25 mm.